

Test Extruder (E) Motor

[JellyBox HowTo: Test Extruder \(E\) Motor](#)

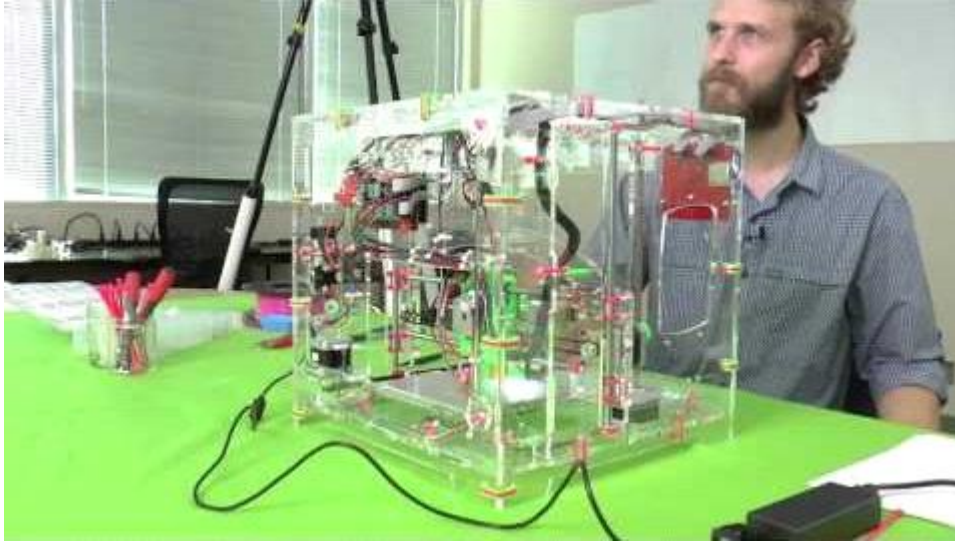

In this video, we test if the extruder motor is spinning.



Title: Preheating the Nozzle

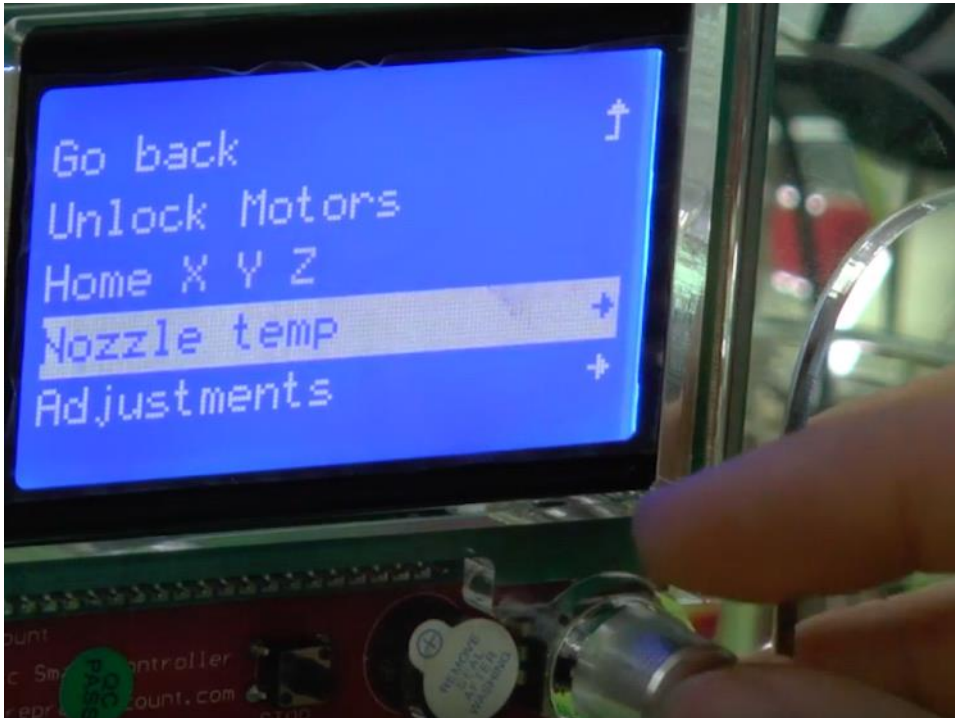

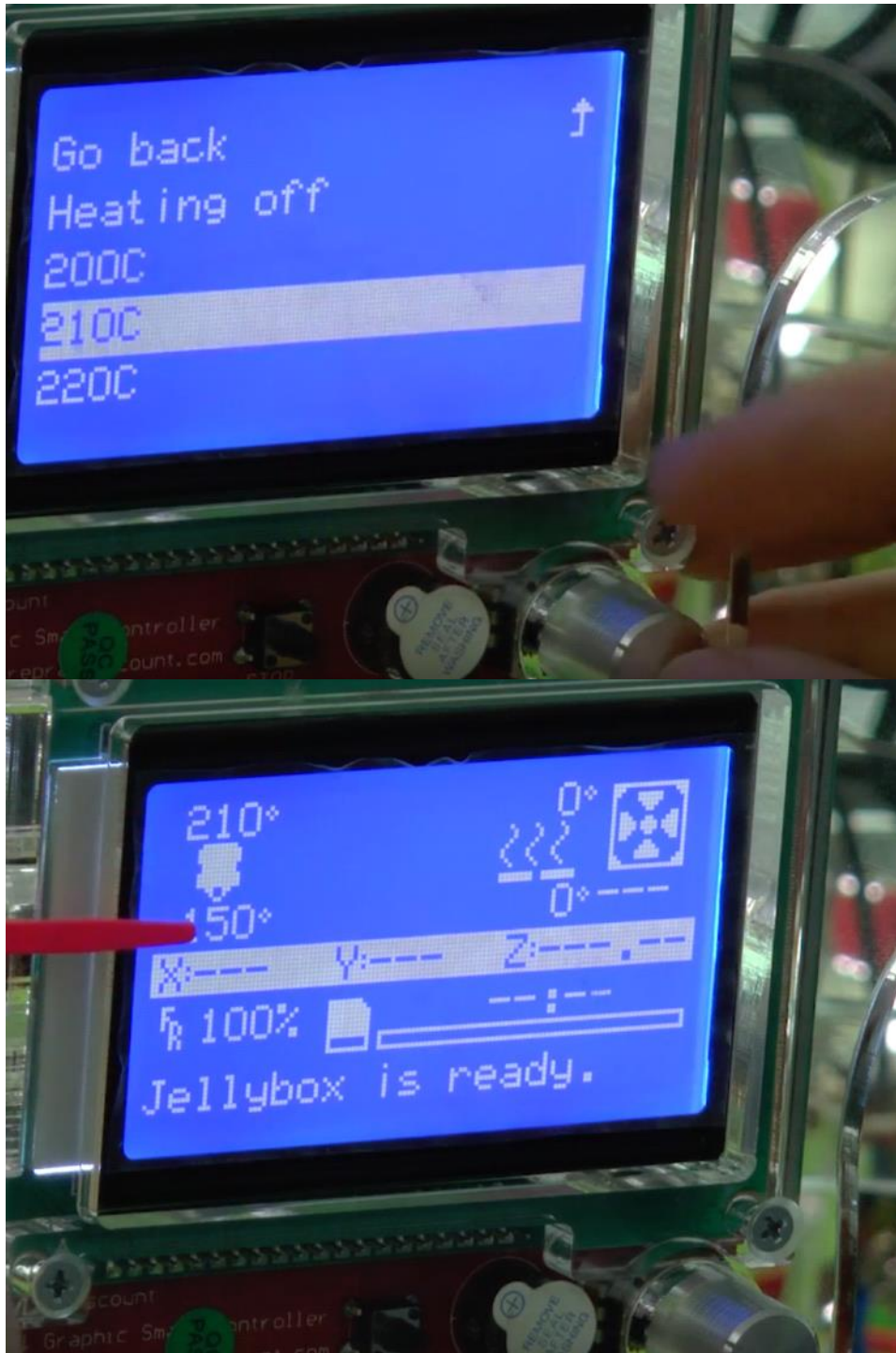

The JellyBox has cold extrusion prevention. It stops the printer from trying to extrude and causing a jam if the nozzle is too cold.

Thus, you have to preheat the nozzle to be able to test the E motor.

In this picture, "210" in the upper right corner is the 'desired temperature' and "150" is the 'current temperature'.

Simply select "Nozzle Temp" in the menu and pick 210C. Then, wait for the temperature to climb up.

Title: Testing the Extruder Motor

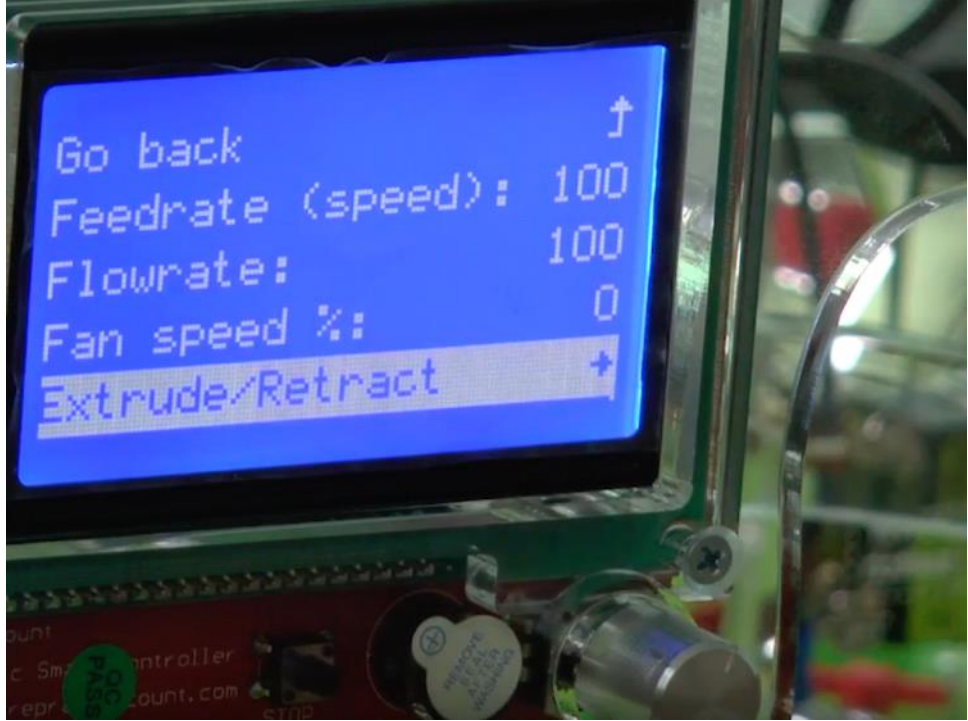
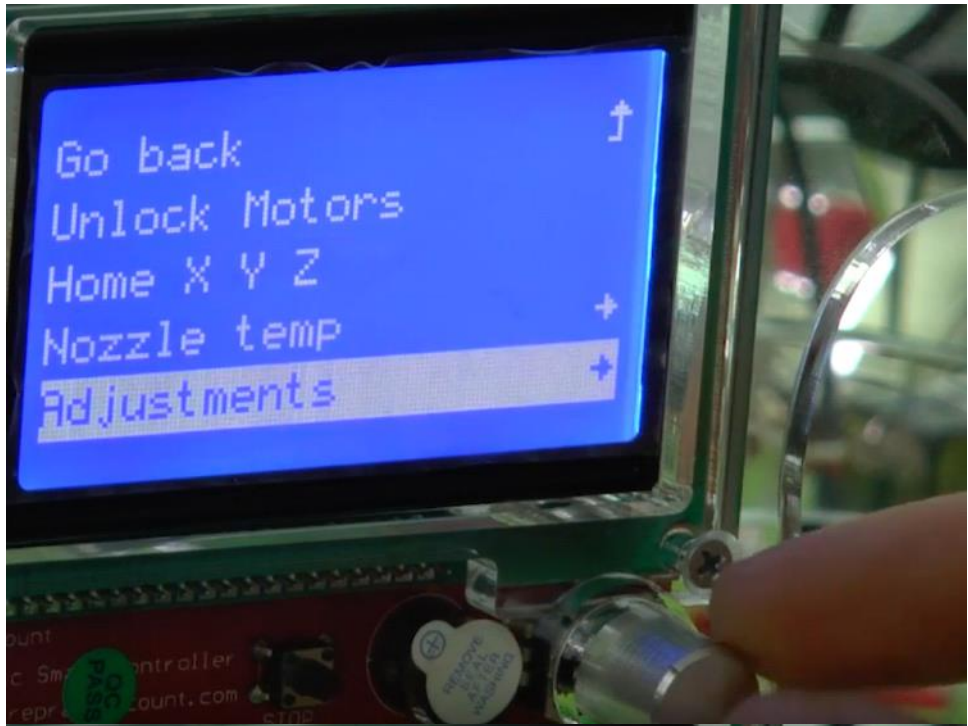

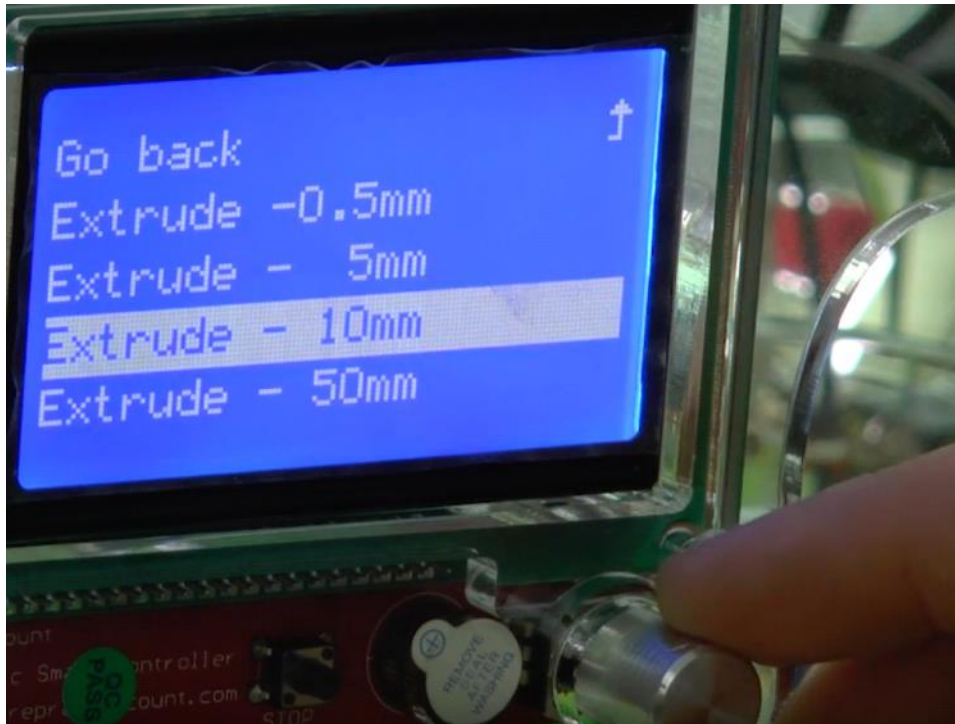

Find "Extrude/Retract" under the "Adjustments" menu.

Pick an amount to extrude; 10mm is fine for a test.

- ! If it doesn't work, the most common mistake here is not plugging in the E motor!
If you do this, turn everything off before plugging the E motor in and starting again.

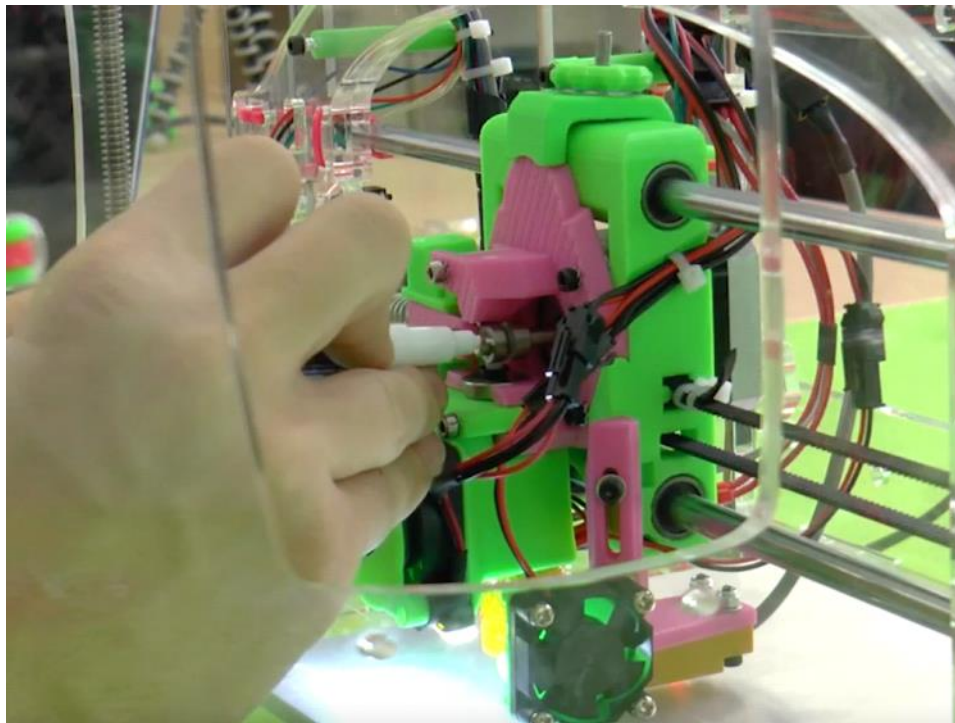

Pro Tip: Make a mark on your drive gear so you can see if it's turning more easily.