

# #prep Y bracket

[JellyBox Build: 04\\_YBracket](#) 2.35min



In this video, we install the Y motor onto the Y motor bracket.

Title: You'll Need:

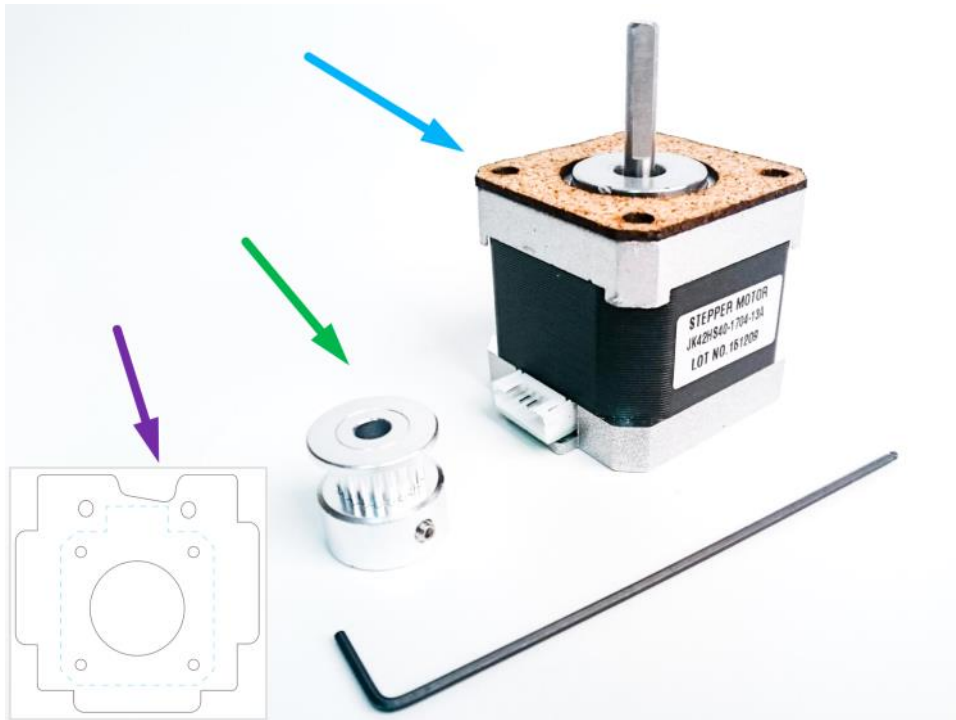

- Y Bracket acrylic piece
- Y Motor (marked with a Y label)
- M3 hex key
- M3x12 bolts (4)
- M3 serrated washers (4)

### Title: Put Serrated Washers on the Bolts

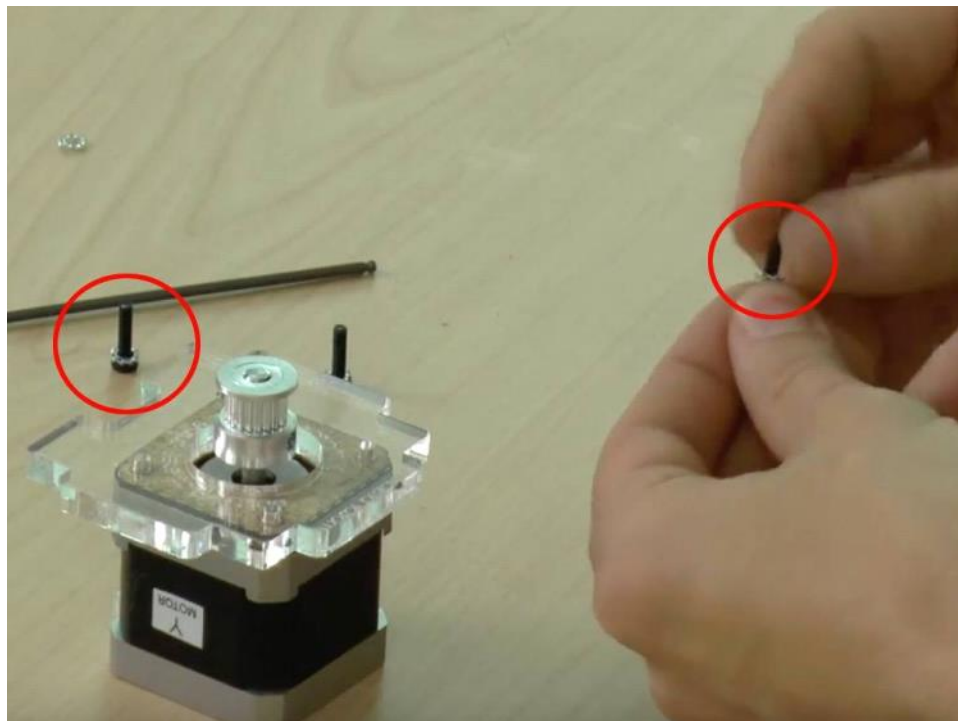

Place one serrated washer on each of the four bolts.

### Title: Align the Y Bracket with the Motor

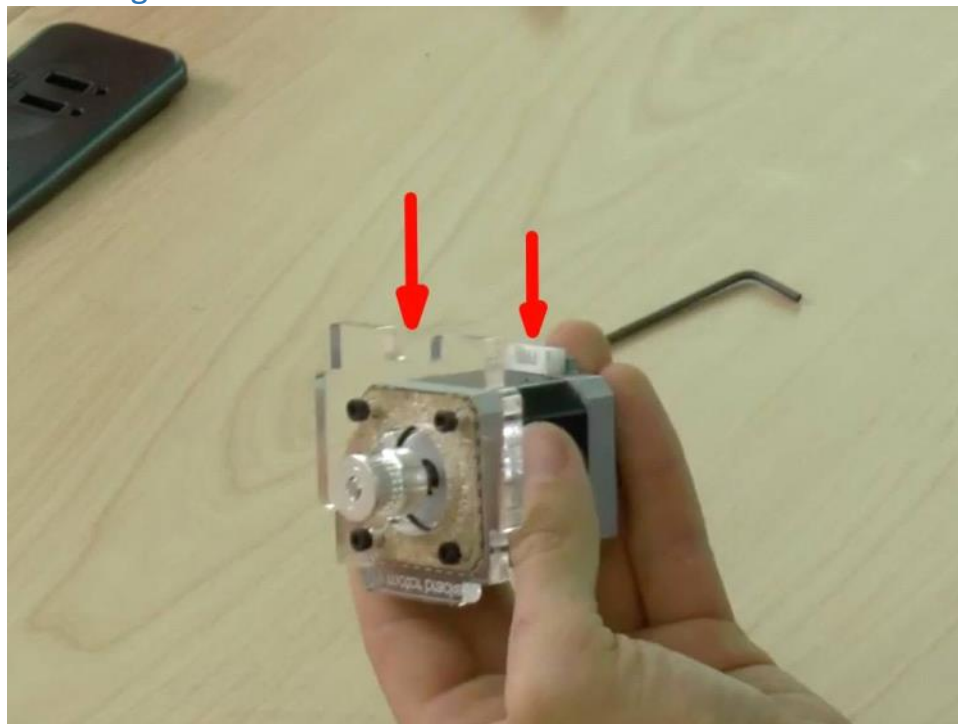

One side of the bracket is marked "Y motor adjoins here to this side".  
Place the motor on that side.  
Align the **notch in the bracket** with the Y motor connector.  
(Don't mind the screws in this picture.)

Title: Fix the Y Bracket to the Motor

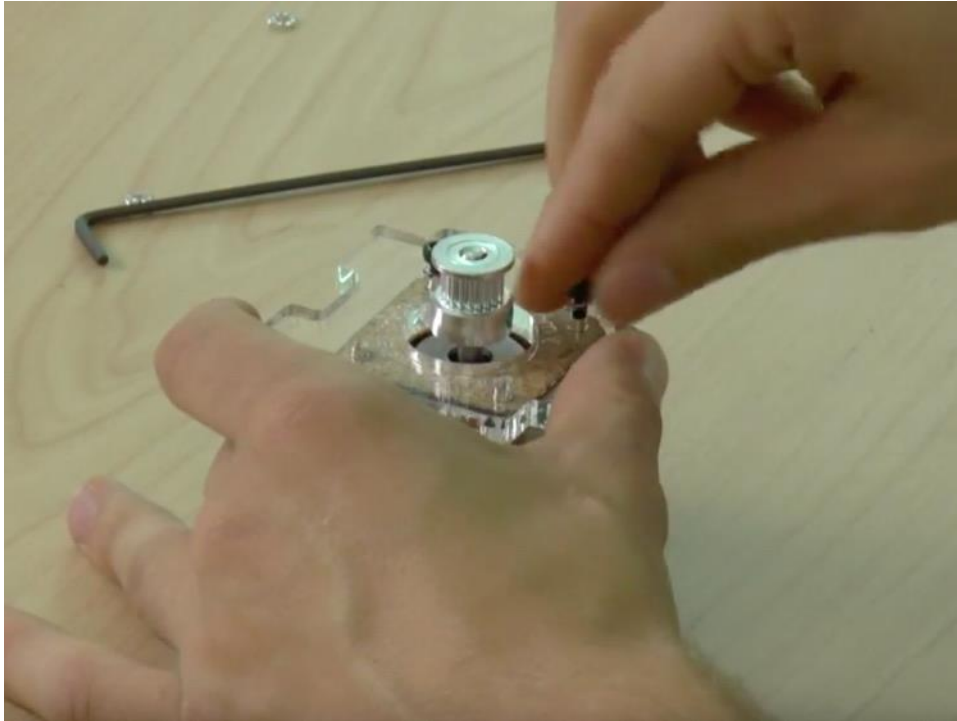

Finger-tighten the bolts into the 4 holes in the motor.

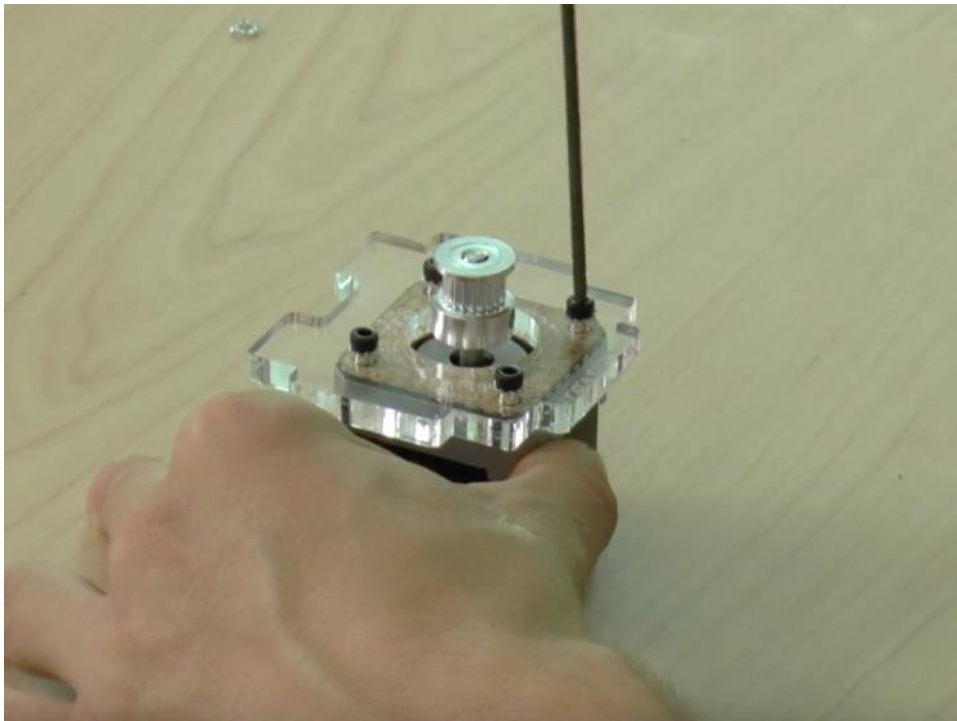

Title: Cross-Tighten the Bolts (aka the RIGHT WAY)



Tighten the bolts with the **short leg** of your M3 hex key. (To avoid overtightening. Good trick.)

- ! Avoid alignment issues by tightening the bolts a little at a time in a diagonal pattern; so called **cross-tightening**. See the video for an example. All the cool kids do it.